

⚡ Specifications

Nominal Voltage(V)

12V

Nominal Capacity

| | | |
|--------------|-------------------|---------|
| 20 hour rate | (1.3A to 10.50V) | 26Ah |
| 10 hour rate | (2.47A to 10.50V) | 24.7Ah |
| 5 hour rate | (4.42A to 10.20V) | 22.1Ah |
| 1 C | (26A to 9.60V) | 14.73Ah |
| 3 C | (78A to 9.60V) | 10.4Ah |

Weight

Approx. 9.3kg(20.5Lbs.)

Internal Resistance (at 1KHz)

Approx. 9.5 mΩ

Maximum Discharge Current for

5 seconds: 390A

Charging Methods at 25°C(77°F)

| | |
|----------------------------|----------------|
| Cycle use: | |
| Charging Voltage | 14.4 to 15.0V |
| Coefficient | -5.0mV/°C/cell |
| Maximum Charging Current : | 7.8A |
| Standby use: | |
| Float Charging Voltage | 13.5 to 13.8V |
| Coefficient | -3.0mV/°C/cell |

Operating Temperature Range

| | | | |
|-----------|------------|----|-------------|
| Charge | -15°C(5°F) | to | 40°C(104°F) |
| Discharge | -15°C(5°F) | to | 50°C(122°F) |
| Storage | -15°C(5°F) | to | 40°C(104°F) |

Charge Retention (shelf life) at 20°C(68°F)

| | |
|---------|-----|
| 1 month | 97% |
| 3 month | 92% |
| 6 month | 85% |

Case Material

ABS UL94 HB
Option: Flammability resistance of (UL94 V-0)

Design Life

3-5 Years.

Terminal

F6



⚡ Dimensions

| | |
|---------------------|---|
| Length (L) | 166± ² ₋₁ (6.54± ^{0.08} _{-0.04}) |
| Width (W) | 175± ² ₋₁ (6.89± ^{0.08} _{-0.04}) |
| Height (H) | 125± ² ₋₁ (4.92± ^{0.08} _{-0.04}) |
| Overall Height (HT) | 125± ² ₋₁ (4.92± ^{0.08} _{-0.04}) |

Description of torque value of hard ware for the terminals:

| | |
|--------------------------------|----------------------|
| Recommended torque value | M5: 4 N-m (41kgf-cm) |
| Maximum allowable torque value | M5: 6 N-m (61kgf-cm) |
| | mm(inch) |

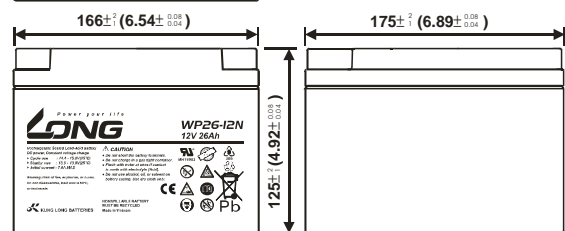
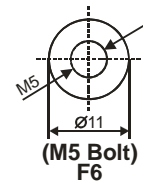
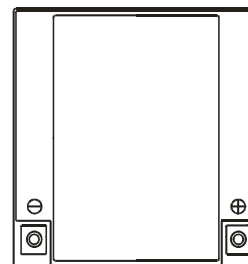

(v) FOR 12V BATTERY Discharge Time VS. Discharge Current (25°C)

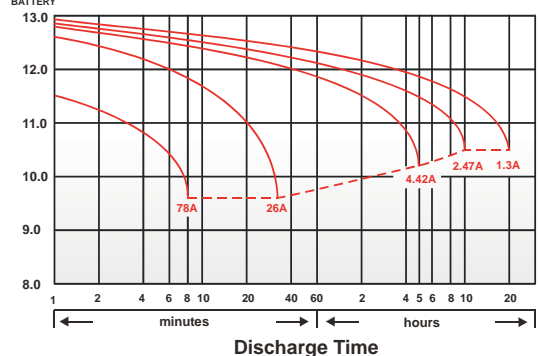

Effect of Temperature on Capacity 25°C (77°F)

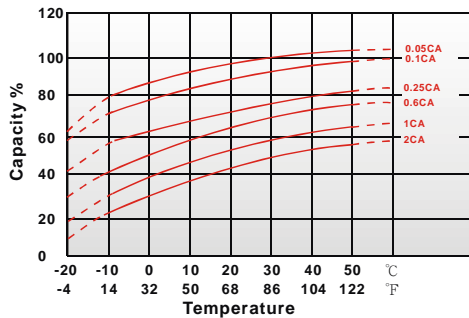

Capacity Retention Characteristic

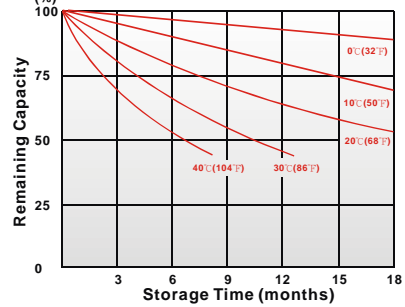

Cycle Service Life

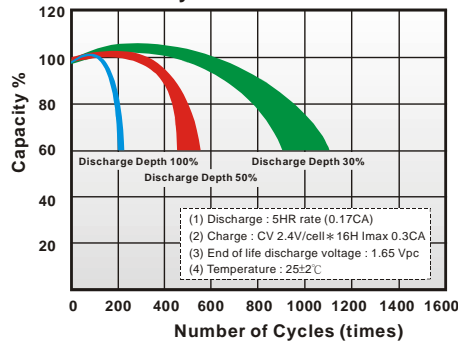

Trickle (or float) Service Life

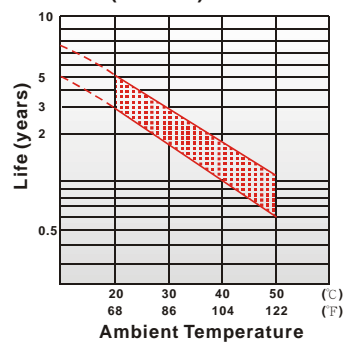

- PERFORMANCE DATA

Discharge Rates in Watts to Various End Voltages at 25°C (77°F)

| End Voltage | | 1.85V | 1.80V | 1.75V | 1.70V | 1.67V | 1.65V | 1.60V |
|-------------|-----|-------|-------|-------|-------|-------|-------|-------|
| Time | | | | | | | | |
| 5 | min | 134 | 157 | 170 | 177 | 183 | 189 | 194 |
| 10 | min | 104 | 114 | 119 | 124 | 129 | 131 | 133 |
| 15 | min | 75.6 | 88.5 | 95.6 | 98.9 | 101 | 103 | 104 |
| 30 | min | 42.3 | 45.3 | 47.2 | 48.7 | 49.7 | 50.5 | 51.3 |
| 60 | min | 29.6 | 30.8 | 31.8 | 32.4 | 33.0 | 33.5 | 33.9 |
| 120 | min | 18.8 | 19.4 | 19.8 | 20.2 | 20.5 | 20.7 | 20.9 |
| 180 | min | 12.5 | 12.9 | 13.1 | 13.3 | 13.5 | 13.7 | 14.0 |
| 240 | min | 10.1 | 10.3 | 10.5 | 10.6 | 10.8 | 10.9 | 11.0 |
| 300 | min | 8.59 | 8.77 | 8.91 | 8.96 | 8.99 | 9.01 | 9.02 |
| 600 | min | 4.80 | 4.90 | 4.94 | 4.97 | 4.99 | 5.01 | 5.03 |
| 1200 | min | 2.57 | 2.62 | 2.65 | 2.68 | 2.71 | 2.74 | 2.76 |

- Discharge Rates in Amperes to Various End Voltages at 25°C (77°F)

| End Voltage | | 1.85V | 1.80V | 1.75V | 1.70V | 1.67V | 1.65V | 1.60V |
|-------------|-----|-------|-------|-------|-------|-------|-------|-------|
| Time | | | | | | | | |
| 5 | min | 70.1 | 79.7 | 87.6 | 91.1 | 94.1 | 97.0 | 99.1 |
| 10 | min | 55.6 | 62.7 | 64.8 | 66.1 | 67.4 | 68.7 | 69.9 |
| 15 | min | 43.8 | 45.7 | 48.8 | 49.8 | 50.7 | 51.6 | 52.5 |
| 30 | min | 25.2 | 27.8 | 28.9 | 29.8 | 30.5 | 31.1 | 31.7 |
| 60 | min | 15.0 | 15.6 | 16.2 | 16.5 | 16.8 | 17.2 | 17.5 |
| 120 | min | 9.12 | 9.35 | 9.60 | 9.70 | 9.80 | 9.89 | 10.0 |
| 180 | min | 6.32 | 6.45 | 6.59 | 6.73 | 6.87 | 7.00 | 7.13 |
| 240 | min | 5.37 | 5.48 | 5.54 | 5.60 | 5.65 | 5.70 | 5.74 |
| 300 | min | 4.38 | 4.46 | 4.51 | 4.55 | 4.60 | 4.64 | 4.69 |
| 600 | min | 2.40 | 2.44 | 2.48 | 2.49 | 2.51 | 2.53 | 2.55 |
| 1200 | min | 1.27 | 1.29 | 1.32 | 1.33 | 1.34 | 1.35 | 1.36 |

All data on the spec. sheet is an average value:

The tolerance range : X<6min(+15%~-15%), 6min ≤ X<10min(+12%~-12%), 10min ≤ X<60min(+8%~-8%), X ≥ 60min(+5%~-5%)

250324-1Q